



**Energy Efficient:**

One 12" (305mm) red segment uses 1.5 watts per foot for red, clear red, amber and orange.  
2.8 watts per foot for white, green, and blue.

Maximum distance for power cable to Flex-Led strip is 30 feet (10 m).  
Power supplies are available in ranges from 60 to 300 watts.

**UL file No. E220835**

**Construction:**

Tube : Acrylic DR™ - UV resistant, extremely durable  
Track : Acrylic DR™ - UV resistant, extremely durable

**ORDERING INFORMATION**

**ASSEMBLY**

SVBL4-RED	4FT. BORDERLIGHT, RED
SVBL8-RED	8FT. BORDERLIGHT, RED
SVBL4-BLUE	4FT. BORDERLIGHT, BLUE
SVBL8-BLUE	8FT. BORDERLIGHT, BLUE
SVBL4-GREEN	4FT. BORDERLIGHT, GREEN
SVBL8-GREEN	8FT. BORDERLIGHT, GREEN
SVBL4-WHITE	4FT. BORDERLIGHT, WHITE
SVBL8-WHITE	8FT. BORDERLIGHT, WHITE
SVBL4-ORANGE	4FT. BORDERLIGHT, ORANGE
SVBL8-ORANGE	8FT. BORDERLIGHT, ORANGE
SVBL4-AMBER	4FT. BORDERLIGHT, AMBER
SVBL8-AMBER	8FT. BORDERLIGHT, AMBER

**POWER SUPPLY**

EVPS25-UL	12VDC, 25 WATT POWER SUPPLY, UL LISTED
-----------	--

**JUMPER CABLES**

FXPC1	1" JUMPER CABLE
FXPC4	4" JUMPER CABLE
FXPC8	8" JUMPER CABLE
FXPC12	12" JUMPER CABLE
FXPC24	24" JUMPER CABLE
FXPC48	48" JUMPER CABLE
FXPC120	120" JUMPER CABLE



**Energy Efficient:**

One 12" (305mm) red segment uses 1.5 to 1.8 watts per foot deep red, clear red, amber, and orange.  
3.2 watts per foot for green, and blue  
Maximum distance for power cable to FlexLED strip is 30 feet (10m)  
Power supplies are available in ranges from 60 to 300 watts.

**UL/ cUL/ ETL (tested to UL48)**

**Number of LEDs per strip -**

- 18 - Clear Red
- 24 - Green, Blue
- 25 - Deep Red, Orange, Amber

**ORDERING INFORMATION**

**FLEX-LED STRIP**

10.0300	12" FLEX-LED STRIP, RED
10.0301	12" FLEX-LED STRIP, CLEAR RED
10.0302	12" FLEX-LED STRIP, AMBER
10.0303	12" FLEX-LED STRIP, BLUE
10.0304	12" FLEX-LED STRIP, GREEN
10.0306	12" FLEX-LED STRIP, ORANGE
10.0309-5	12" FLEX-LED STRIP, COOL WHITE
10.0309-6	12" FLEX-LED STRIP, WARM WHITE

**MOUNTING CLIP**

FXCLIP	MOUNTING CLIP, 30 PER BAG
--------	---------------------------



Flex-LED Starter-kit

SUPER VISION INTERNATIONAL  
8210 PRESIDENTS DRIVE  
ORLANDO, FLORIDA 32809  
USA

PH 407.857.9900  
FAX 407.857.0050

WWW.SVISION.COM  
NASDAQ: SUPVA

IMAGINATION

SVi

COLOR

+

LIGHT



SUPER VISION  
INTERNATIONAL

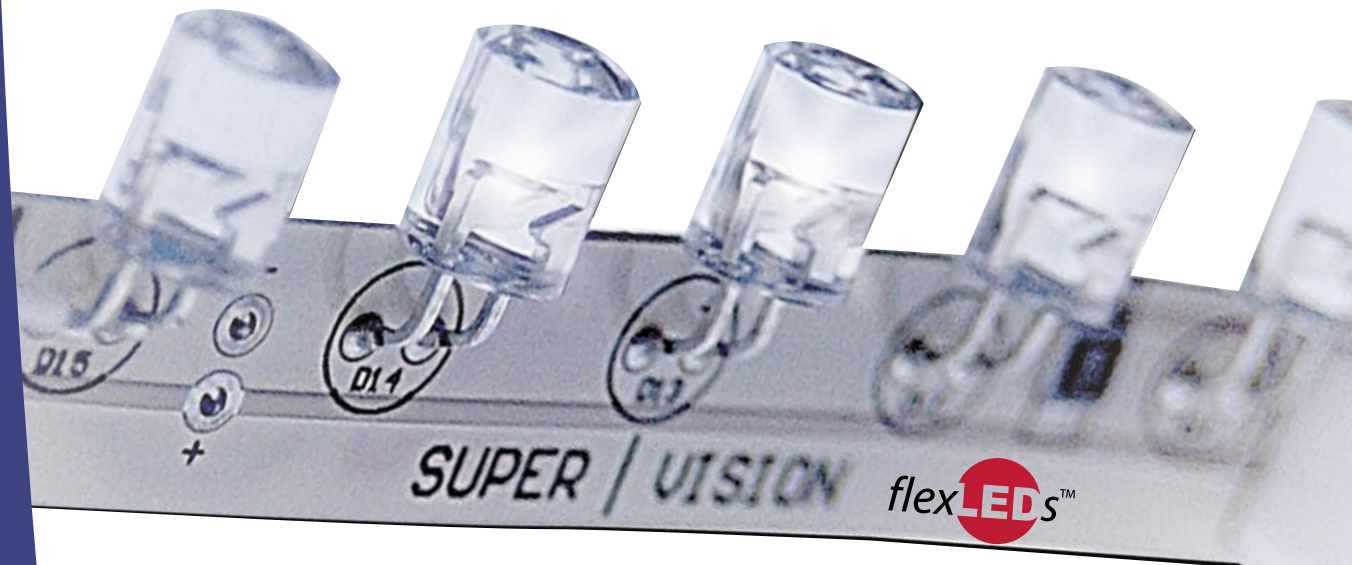

Border Light is a neon alternative, low voltage, monochromatic, LED tube designed specifically for building perimeter lighting or linear lighting applications. LEDs produce very little heat and have a long lamp life expectancy.

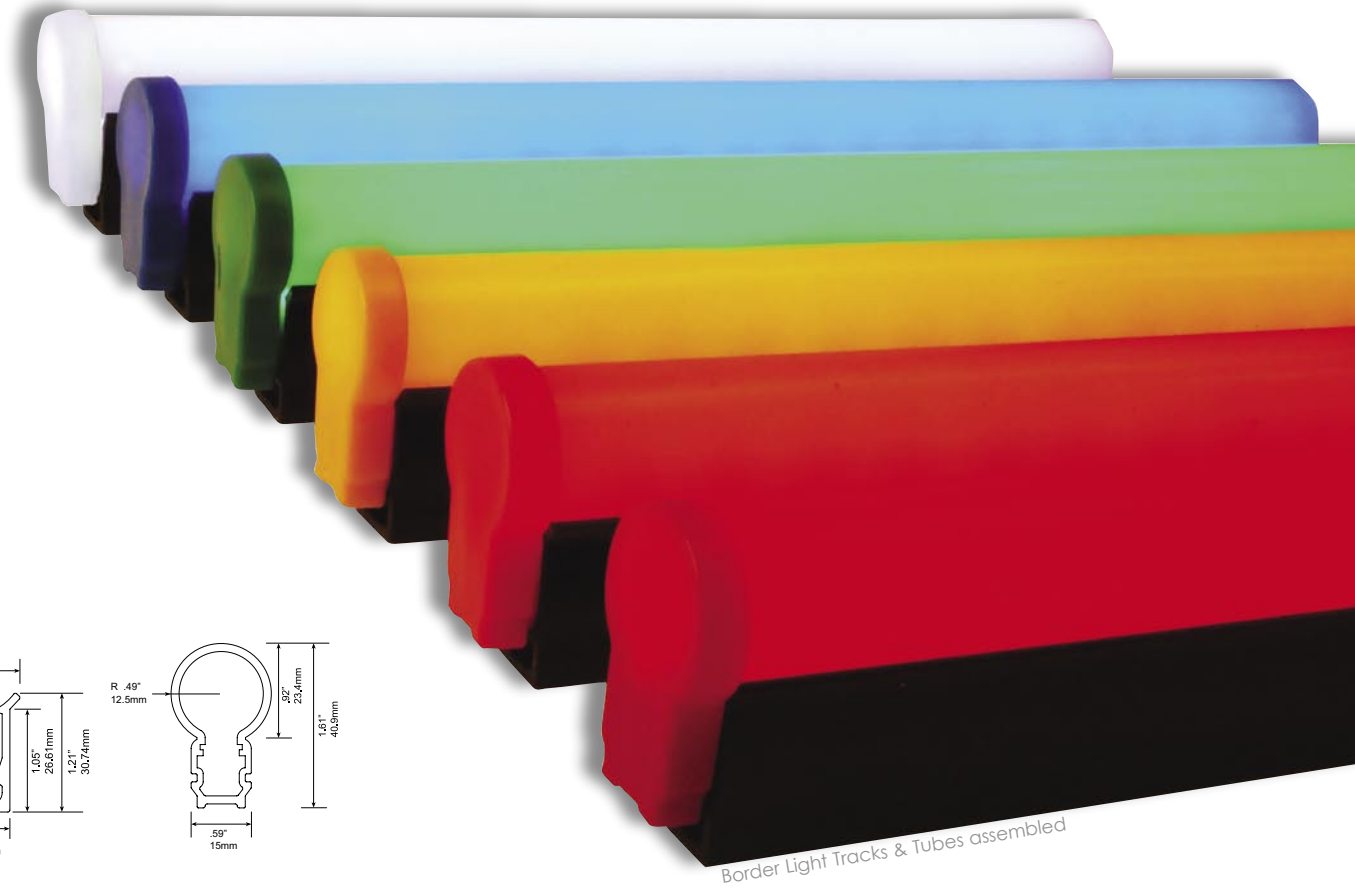
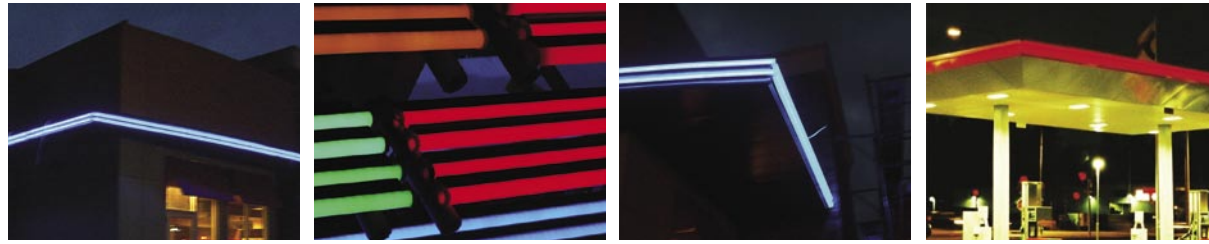

# BUILDING PERIMETER LIGHTING

A NEON REPLACEMENT FOR BUILDING OUTLINES, SIGNS AND ARCHITECTURAL APPLICATIONS.

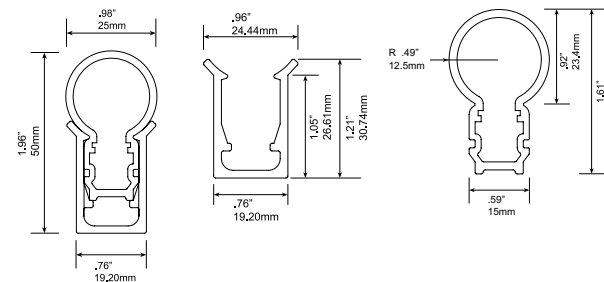

Border Light tracks & Tubes assembled

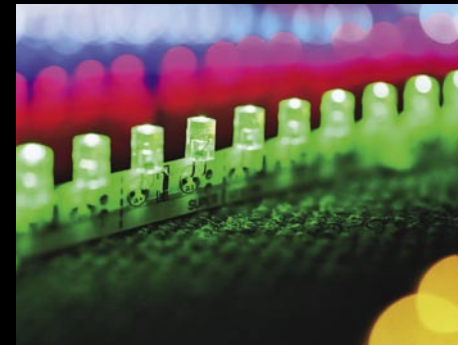
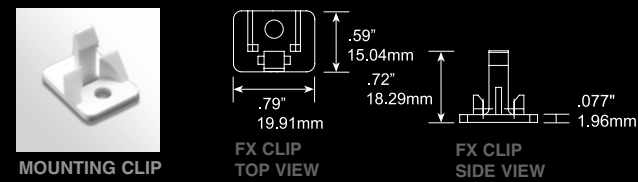

Flex-LED is a low voltage - 12VDC, flexible, monochromatic, LED strip designed especially for illuminating channel or back-lit, letters and logo's. LEDs produces very little heat and have a long lamp life expectancy. Flex-LED is easy to install. BEND IT. CUT IT. CONNECT IT.

# THE ORIGINAL FLEXIBLE LED STRIP

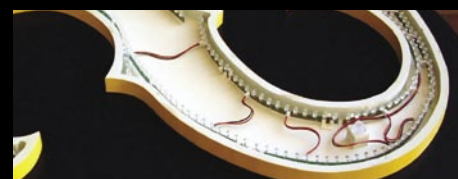
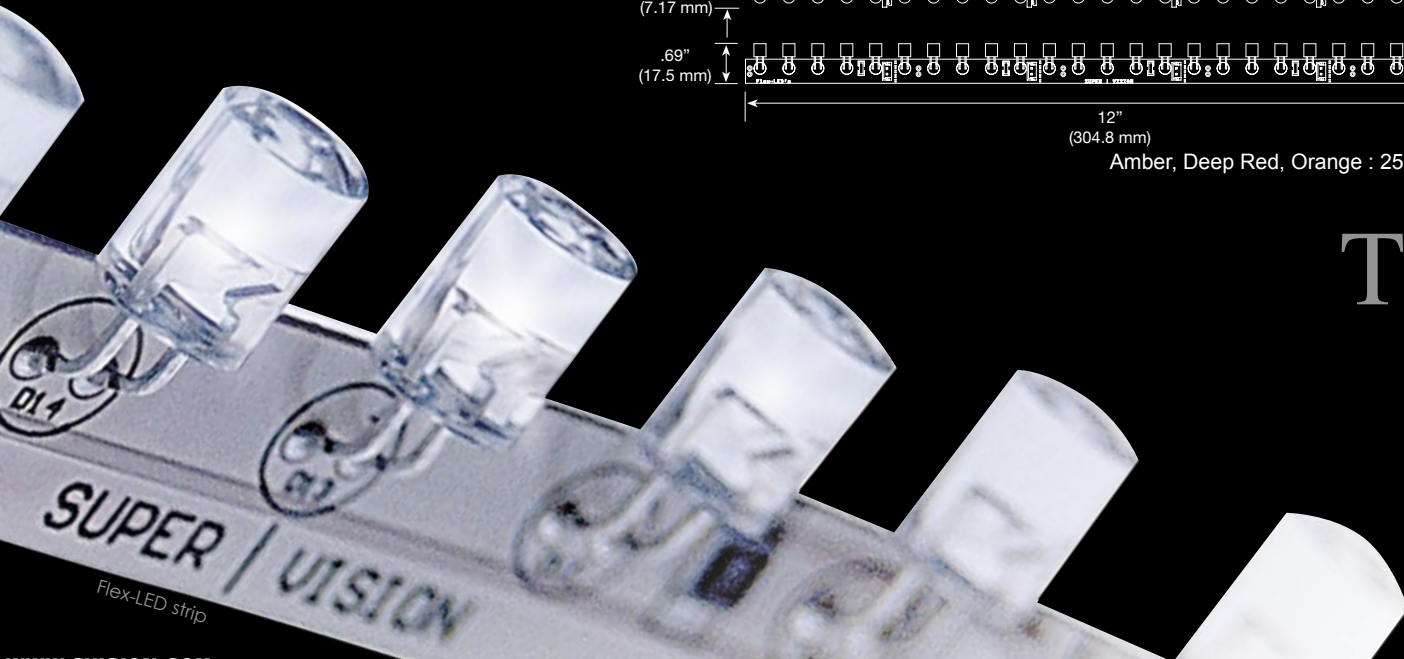

FOR CHANNEL LETTERS, THIN STROKE LETTERS & HALO OR BACKLIT LETTERS